

# Kit 1107

**DAEWOO Lanos**, 4-dr Sedan, 97-03

**DAEWOO Lanos**, 5-dr Hatchback, 97-03

**DAEWOO Lanos**, 3-dr Hatchback, 98-03

**DAEWOO Leganza**, 4-dr Sedan, 97-02

**DAEWOO Nubira**, 4-dr Sedan, 97-99

**DAEWOO Nubira II**, 4-dr Sedan, 00-02

480R  
754

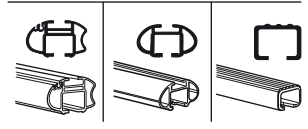
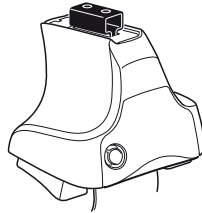

480

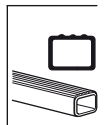
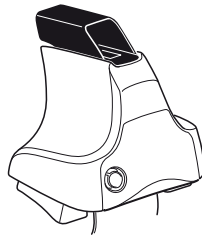

750

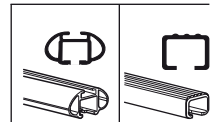
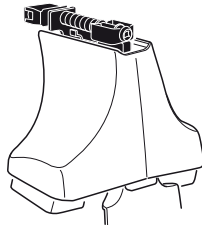

**THULE**<sup>®</sup>  
SWEDEN

ISO 11154-E

**Max. 75kg**  
**Max. 165 lbs**

x1

x4

x4

x4  
 x4

**480R/754**

---

x1

x4

x4

x4

**480**

---

x1

x4

x4

**750**

|                      |    |                      |          |    |
|----------------------|----|----------------------|----------|----|
|                      |    |                      |          |    |
| x2<br>x2<br>x2<br>x4 | x2 | x2<br>x2<br>x4<br>x4 | x2<br>x2 | x2 |

**115** x4

**204** x2

**03** x4

x1

**Kit**



**3**

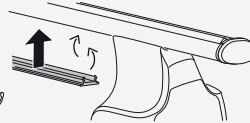
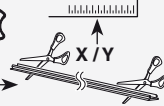

**1**

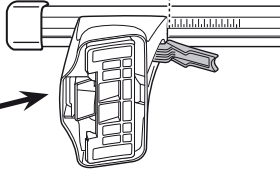

**2**

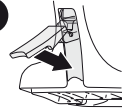

|  | X           |
|--|-------------|
| <b>DAEWOO Lanos, 4-dr Sedan, 97-03</b>     | <b>22,5</b> |
| <b>DAEWOO Lanos, 5-dr Hatchback, 97-03</b> | <b>22,5</b> |
| <b>DAEWOO Lanos, 3-dr Hatchback, 98-03</b> | <b>23</b>   |
| <b>DAEWOO Leganza, 4-dr Sedan, 97-02</b>   | <b>32</b>   |
| <b>DAEWOO Nubira, 4-dr Sedan, 97-99</b>    | <b>27,5</b> |
| <b>DAEWOO Nubira II, 4-dr Sedan, 00-02</b> | <b>27,5</b> |

**1**

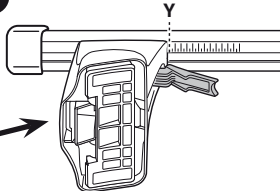
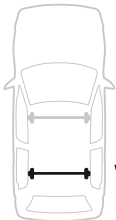

**2**

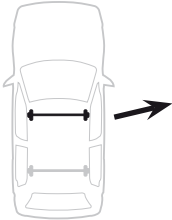
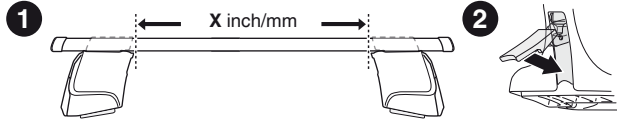

|  | Y           |
|--|-------------|
| <b>DAEWOO Lanos, 4-dr Sedan, 97-03</b>     | <b>22</b>   |
| <b>DAEWOO Lanos, 5-dr Hatchback, 97-03</b> | <b>22</b>   |
| <b>DAEWOO Lanos, 3-dr Hatchback, 98-03</b> | <b>21,5</b> |
| <b>DAEWOO Leganza, 4-dr Sedan, 97-02</b>   | <b>29</b>   |
| <b>DAEWOO Nubira, 4-dr Sedan, 97-99</b>    | <b>26,5</b> |
| <b>DAEWOO Nubira II, 4-dr Sedan, 00-02</b> | <b>26,5</b> |

**3**

|                                     | X inch  | X mm   |
|-------------------------------------|---------|--------|
| DAEWOO Lanos, 4-dr Sedan, 97-03     | 34 1/2" | 876 mm |
| DAEWOO Lanos, 5-dr Hatchback, 97-03 | 34 1/2" | 876 mm |
| DAEWOO Lanos, 3-dr Hatchback, 98-03 | 34 5/8" | 881 mm |
| DAEWOO Leganza, 4-dr Sedan, 97-02   | 38 1/4" | 971 mm |
| DAEWOO Nubira, 4-dr Sedan, 97-99    | 36 1/2" | 926 mm |
| DAEWOO Nubira II, 4-dr Sedan, 00-02 | 36 1/2" | 926 mm |

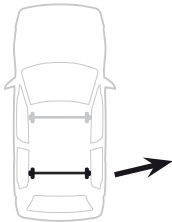
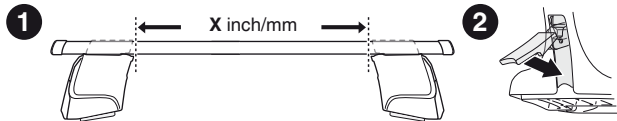

|                                     | Y inch  | Y mm   |
|-------------------------------------|---------|--------|
| DAEWOO Lanos, 4-dr Sedan, 97-03     | 34 1/4" | 871 mm |
| DAEWOO Lanos, 5-dr Hatchback, 97-03 | 34 1/4" | 871 mm |
| DAEWOO Lanos, 3-dr Hatchback, 98-03 | 34 1/8" | 866 mm |
| DAEWOO Leganza, 4-dr Sedan, 97-02   | 37"     | 941 mm |
| DAEWOO Nubira, 4-dr Sedan, 97-99    | 36 1/8" | 916 mm |
| DAEWOO Nubira II, 4-dr Sedan, 00-02 | 36 1/8" | 916 mm |

**4**

DAEWOO Lanos, 3-dr Hatchback, 98-03

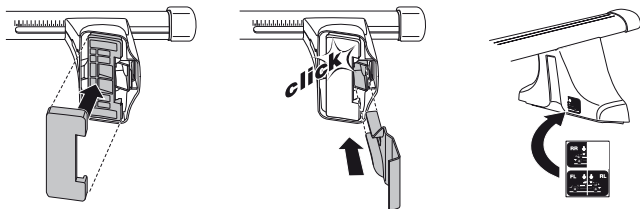
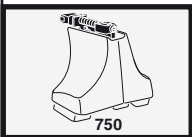
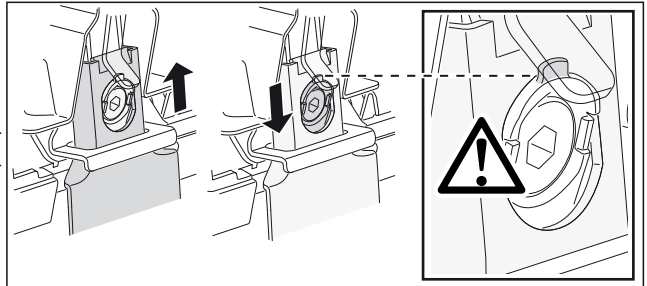
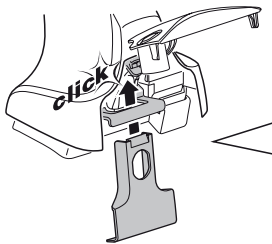
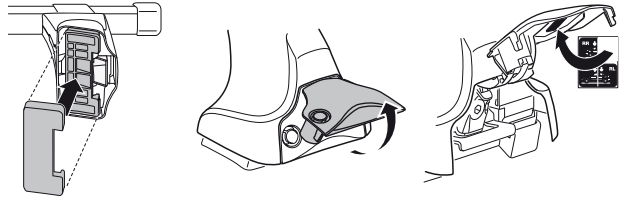
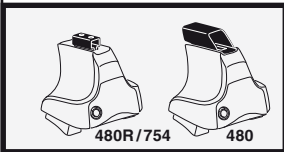
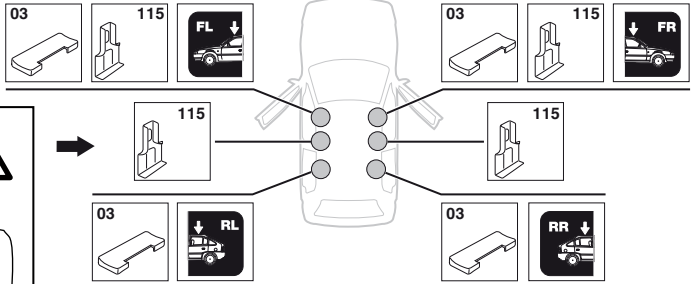
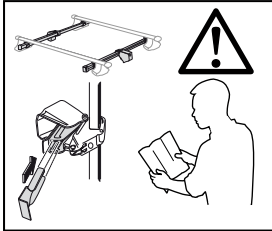
**SRA**

**4**

**DAEWOO Lanos, 4-dr Sedan, 97-03**  
**DAEWOO Lanos, 5-dr Hatchback, 97-03**  
**DAEWOO Nubira, 4-dr Sedan, 97-99**  
**DAEWOO Nubira II, 4-dr Sedan, 00-02**

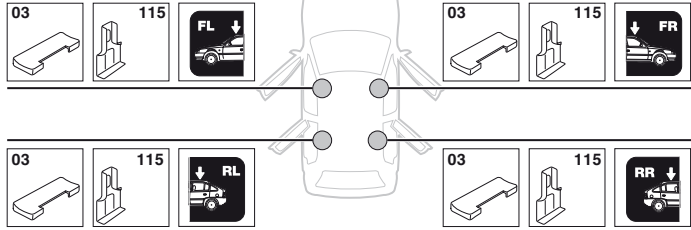

**DAEWOO Leganza, 4-dr Sedan, 97-02**

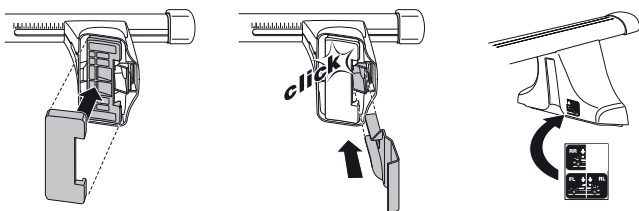
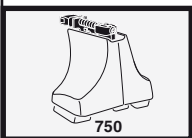
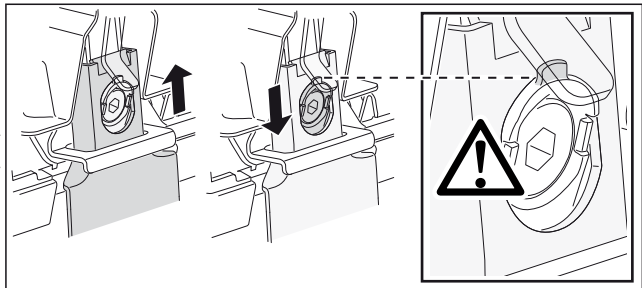
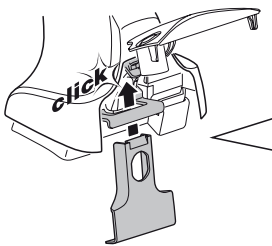
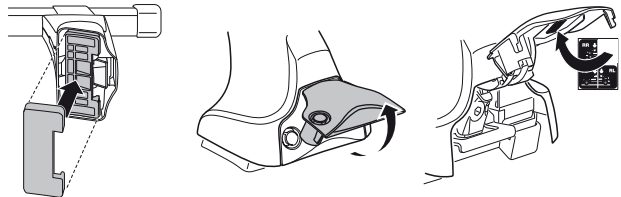
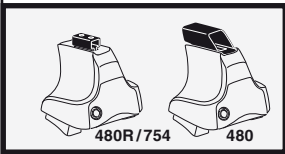
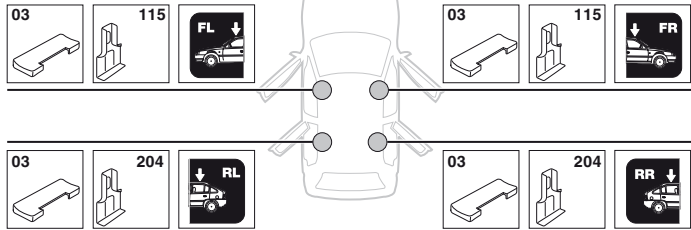

5

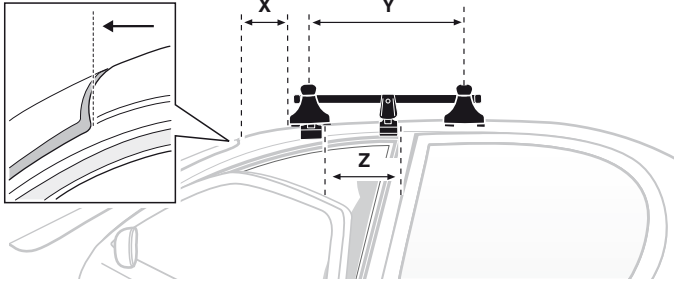
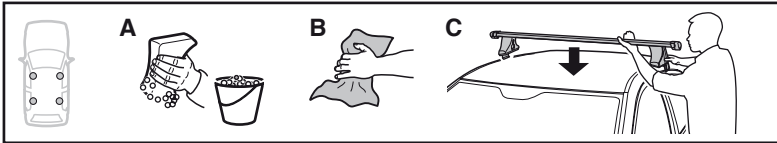

|                                     | X mm   | Y mm   | Z mm   | X inch | Y inch  | X inch  |
|-------------------------------------|--------|--------|--------|--------|---------|---------|
| DAEWOO Lanos, 3-dr Hatchback, 98-03 | 190 mm | 700 mm | 360 mm | 7 1/2" | 27 1/2" | 14 1/8" |

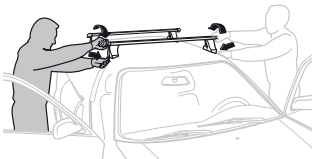
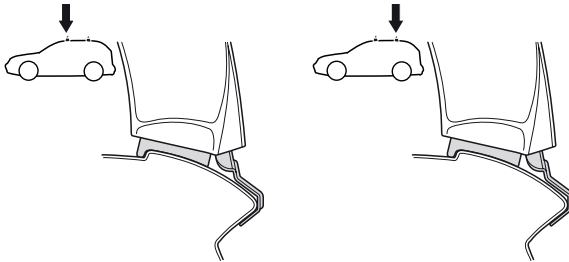

**GB/US** Tighten alternately  
**D** Die Schrauben abwechselnd anziehen  
**F** Serrer alternativement chaque côté  
**NL** Afwisselend aan de linker- en de rechterkant aandraaien  
**I** Alternare il serraggio delle viti  
**E** Apretar alternativamente  
**PT** Aperte alternadamente  
**S** Dra åt växelvis  
**FIN** Kierrä vuorotellen  
**EST** Pinguldage vaheldumisi  
**LAT** Pielvelciēt pamišus  
**LIT** Užsukinėkite pakaitomis  
**PL** Śruby dokręcaj naprzemiennie  
**RU** Затягивайте попеременно

**CZ** Pokręťta bagażnika dokręcaj dokręcaj naprzemiennie.  
**SK** Dotahujte striedavo  
**SLO** Privijajte izmenično.  
**HR** Naizmjenično zategnite  
**HU** Egymástól függetlenül szorítandó  
**GR** Σφιγγετε εναλλάξ  
**TR** Dönüşümlü sıkın

**中文** 交替拧紧

**한국어** 번갈아 가며 조이십시오.

**日本語** 交互に締め付けてください。

**ไทย** ชับในแบบสลับ



5

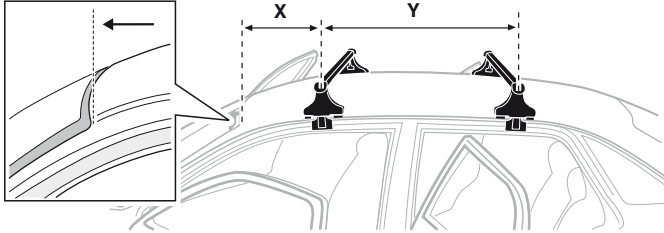
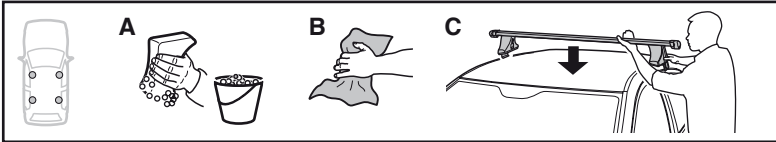

|  | X mm   | Y mm   | X inch | Y inch  |
|--|--------|--------|--------|---------|
| <b>DAEWOO Lanos, 4-dr Sedan, 97-03</b>     | 200 mm | 600 mm | 7 7/8" | 23 5/8" |
| <b>DAEWOO Lanos, 5-dr Hatchback, 97-03</b> | 200 mm | 550 mm | 7 7/8" | 21 5/8" |
| <b>DAEWOO Leganza, 4-dr Sedan, 97-02</b>   | 200 mm | 650 mm | 7 7/8" | 25 5/8" |
| <b>DAEWOO Nubira, 4-dr Sedan, 97-99</b>    | 180 mm | 650 mm | 7 1/8" | 25 5/8" |
| <b>DAEWOO Nubira II, 4-dr Sedan, 00-02</b> | 180 mm | 650 mm | 7 1/8" | 25 5/8" |

**DAEWOO Lanos, 4-dr Sedan, 97-03**  
**DAEWOO Lanos, 5-dr Hatchback, 97-03**  
**DAEWOO Nubira, 4-dr Sedan, 97-99**  
**DAEWOO Nubira II, 4-dr Sedan, 00-02**

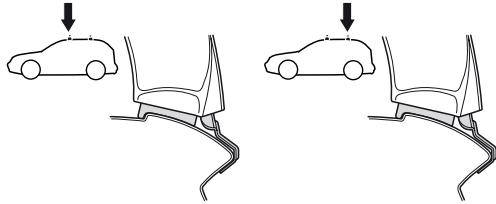

**DAEWOO Leganza, 4-dr Sedan, 97-02**

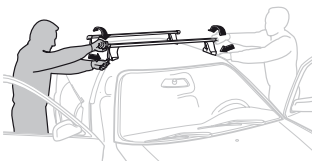
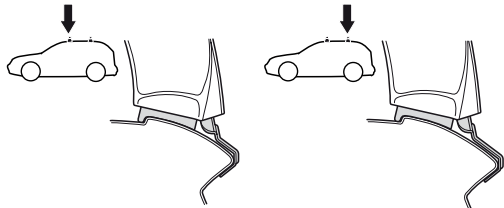

**GB/US** Tighten alternately  
**D** Die Schrauben abwechselnd anziehen  
**F** Serrer alternativement chaque côté  
**NL** Afwisselend aan de linker- en de rechterkant aandraaien  
**I** Alternare il serraggio delle viti  
**E** Apretar alternativamente  
**PT** Aperte alternadamente  
**S** Dra åt växelvis  
**FIN** Kierrä vuorotellen  
**EST** Pinguldage vaheldumisi  
**LAT** Pievelciēt pamišus  
**LIT** Užsukinėkite pakaitomis  
**PL** Śruby dokręcaj naprzemiennie  
**RU** Затягивайте попеременно

**CZ** Pokręťta bagazníka dokręcaj dokręcaj naprzemiennie.  
**SK** Dofahujte striedavo  
**SLO** Privijajte izmenično.  
**HR** Naizmjerno zategnite  
**HU** Egyarástól fűggetlenül szorítandó  
**GR** Σφιγίγτε εναλλάξ  
**TR** Dönüşümlü sıkın

**中文** 交替拧紧  
**한국어** 번갈아 가며 조이십시오.  
**日本語** 交互に締め付けてください。  
**ไทย** ขึ้นในแบบสลับ

6



480R/754



480

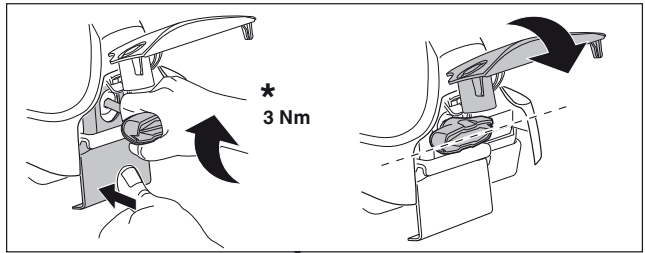
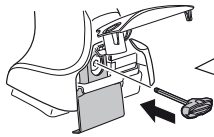

\*  
3 Nm

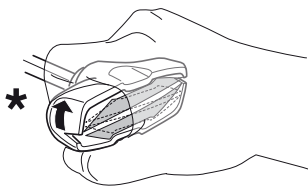

\*

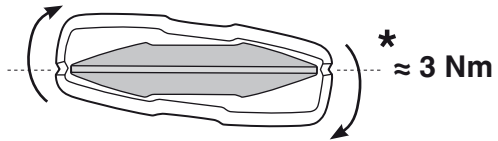

\*  
≈ 3 Nm

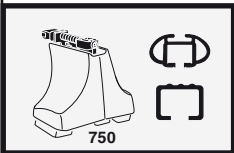
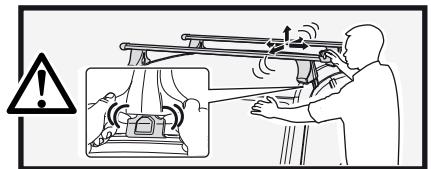

750

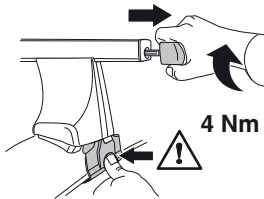

4 Nm

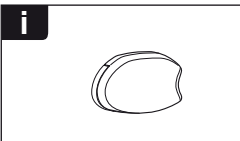
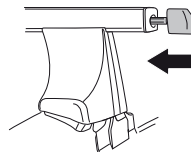

i

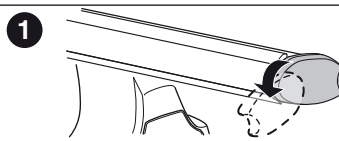

1

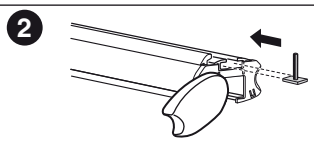

2

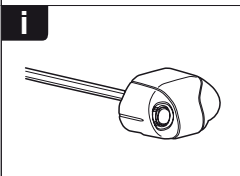

i

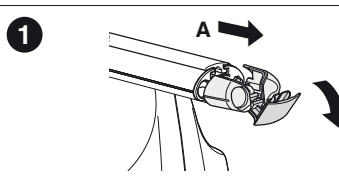

1

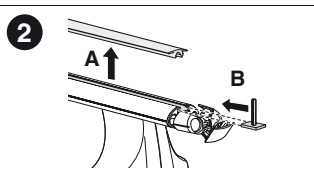

2

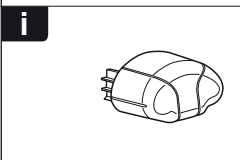

i

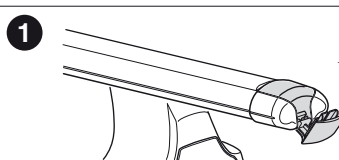

1

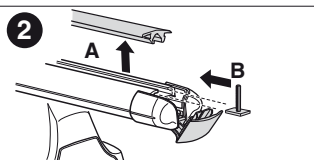

2



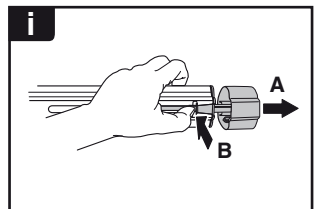
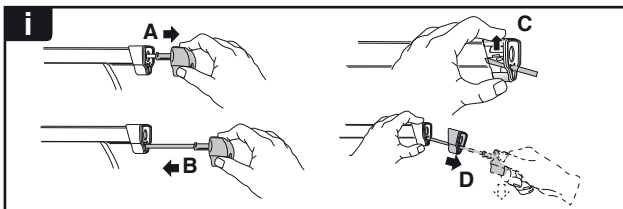
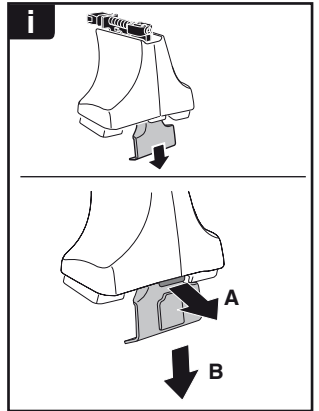
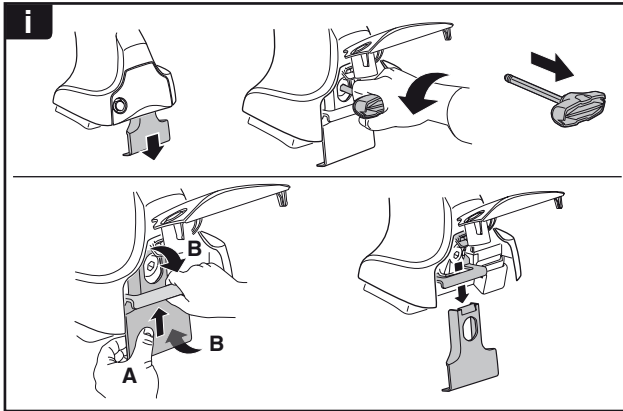
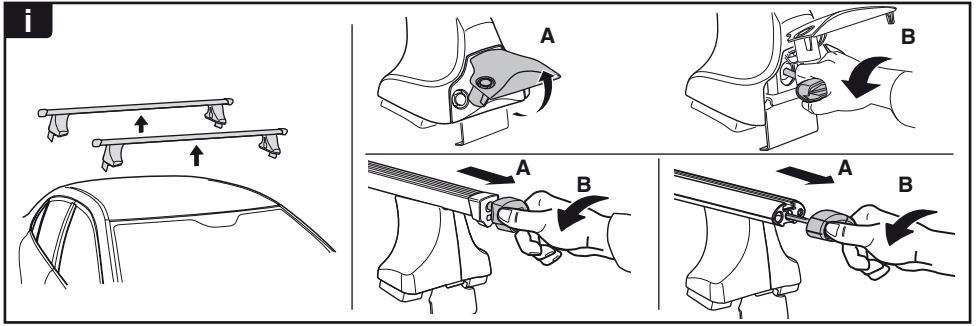

**THULE**  
SWEDEN  
**ONE  
KEY  
SYSTEM**

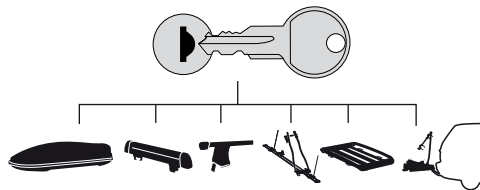

- 544** (x4)
- 596** (x6)
- 588** (x8)
- NA **510** (x10)
- EUR **452** (x12)
- ASIA

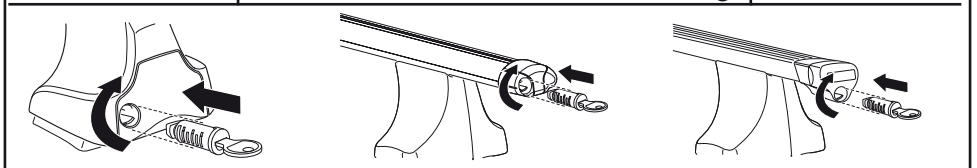

WW ▶ Thule Sweden AB, Box 69, 330 33 Hillerstorp, SWEDEN  
NA ▶ Thule Inc., 42 Silvermine Road, Seymour, Connecticut 06483, USA

info@thule.com  
customer.service@thule.com

www.thule.com