

Kit 1071

TOYOTA Corolla, 3-dr Hatchback, 98-99, 00-03

TOYOTA Corolla, 5-dr Liftback, 98-03

480R
754

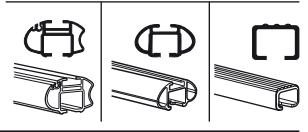
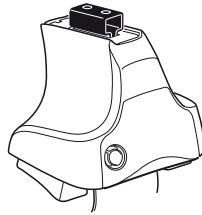

480

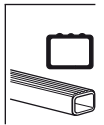
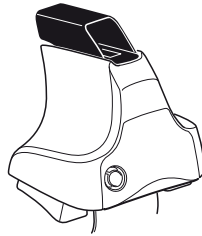

750

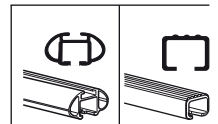
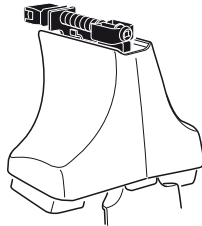

xx kg
 xx lbs + 7 kg / 15,4 lbs = **Max. 50kg**
 3 kg / 6,6 lbs = **Max. 110 lbs**

80 km/h 130 km/h
 50 Mph 80 Mph
 40 km/h 25 Mph
km/h Mph

THULE + **Kit XXXX**

x1 x4 x4 x4 x4
480R/754

x1 x4 x4 x4
480

x1 x4 x4
750

| | | | | |
|----|----|----|----|----|
| | | | | |
| x2 | x2 | x2 | x2 | x2 |
| x2 | | x2 | x2 | |
| x2 | | x4 | | |
| x4 | | x4 | | |

158 x 4 **04** x 4 x 1

Kit



3

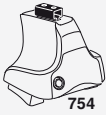

754

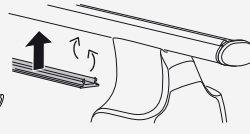
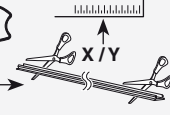

750



1

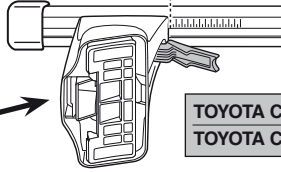
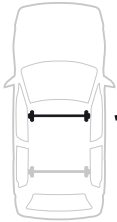

2

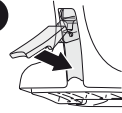

| | X |
|----------------------------------------------|------|
| TOYOTA Corolla, 3-dr Hatchback, 98-99, 00-03 | 29,5 |
| TOYOTA Corolla, 5-dr Liftback, 98-03 | 29,5 |

1

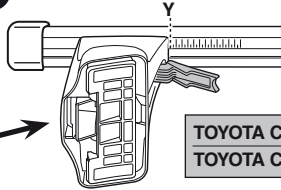

2

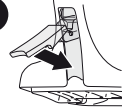

| | Y |
|----------------------------------------------|------|
| TOYOTA Corolla, 3-dr Hatchback, 98-99, 00-03 | 25 |
| TOYOTA Corolla, 5-dr Liftback, 98-03 | 29,5 |



480R



480

1

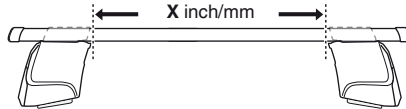
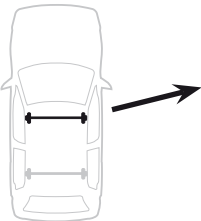

2

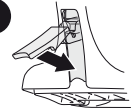

| | X inch | X mm |
|----------------------------------------------|---------|--------|
| TOYOTA Corolla, 3-dr Hatchback, 98-99, 00-03 | 37 1/4" | 946 mm |
| TOYOTA Corolla, 5-dr Liftback, 98-03 | 37 1/4" | 946 mm |

1

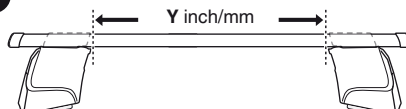
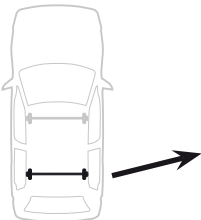

2

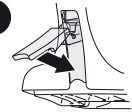

| | Y inch | Y mm |
|----------------------------------------------|---------|--------|
| TOYOTA Corolla, 3-dr Hatchback, 98-99, 00-03 | 35 1/2" | 901 mm |
| TOYOTA Corolla, 5-dr Liftback, 98-03 | 37 1/4" | 946 mm |

4

TOYOTA Corolla, 3-dr Hatchback, 98-99, 00-03



SRA

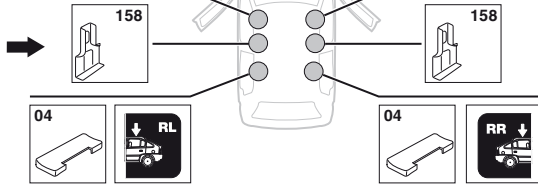
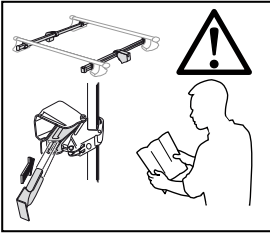

TOYOTA Corolla, 5-dr Liftback, 98-03

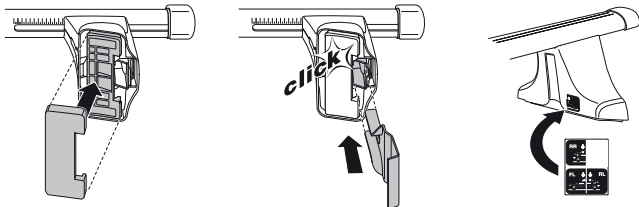
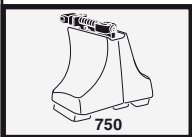
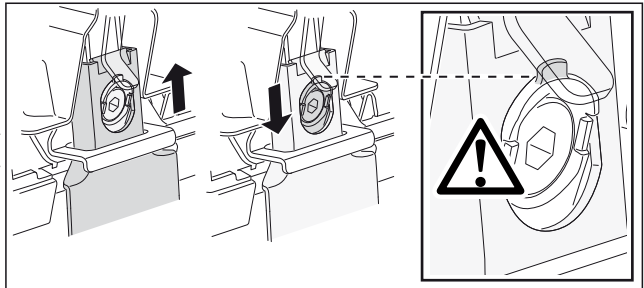
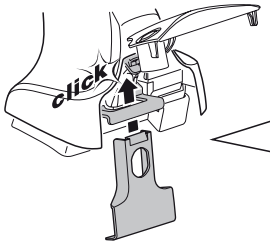
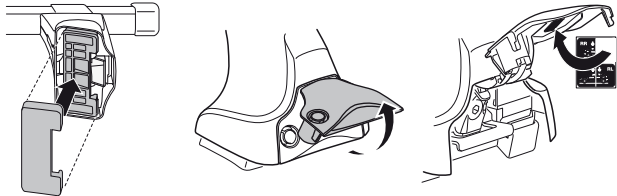
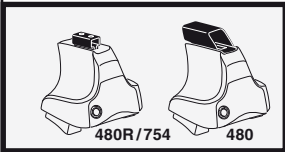
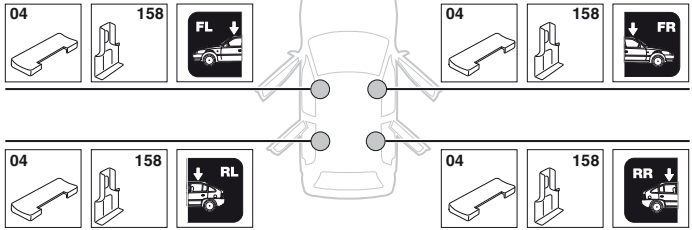

5



| | X mm | Y mm | X inch | Y inch |
|------------------------------------------------------|--------|--------|---------|---------|
| TOYOTA Corolla , 3-dr Hatchback, 98-99, 00-03 | 260 mm | 700 mm | 10 1/4" | 27 1/2" |
| TOYOTA Corolla , 5-dr Liftback, 98-03 | 260 mm | 650 mm | 10 1/4" | 25 5/8" |

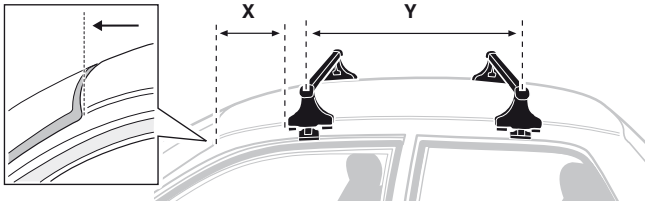

TOYOTA Corolla, 3-dr Hatchback, 98-99, 00-03

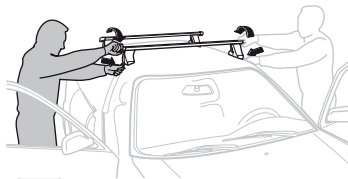
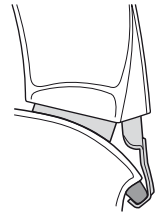
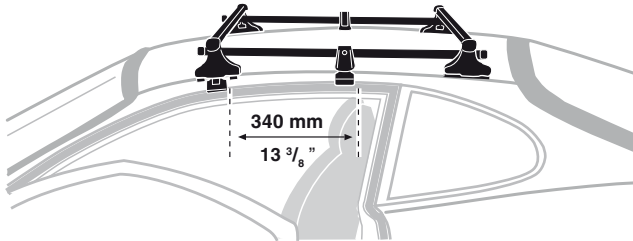

GB/US Tighten alternately

D Die Schrauben abwechselnd anziehen

F Serrer alternativement chaque côté

NL Afwisselend aan de linker- en de rechterkant aandraaien

I Alternare il serraggio delle viti

E Apretar alternativamente

PT Aperte alternadamente

S Dra åt växelvis

FIN Kierrä vuorotellen

EST Pinguldage vaheldumisi

LAT Pielvelciēt pamīšus

LIT Užsukinėkite pakaitomis

PL Śruby dokręcaj naprzemiennie

RU Затягивайте попеременно

CZ Pokręťta bagažníka dokręcaj dokręcaj naprzemiennie.

SK Doťahujte striedavo

SLO Privijajte izmenično.

HR Naizmjenično zategnite

HU Egymástól függetlenül szorítandó

GR Σφιγγετε εναλλάξ

TR Dönüşümlü sıkın

中文 交替拧紧

한국어 번갈아 가며 조이십시오.

日本語 交互に締め付けてください。

ไทย ชั้้นโน้แบบสลับ

6



480R/754



480

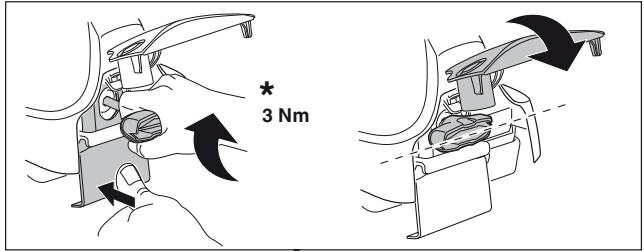
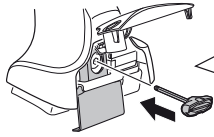

*
3 Nm



*

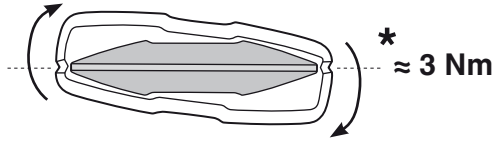

*
≈ 3 Nm

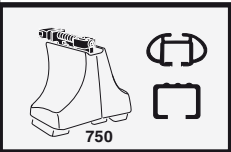
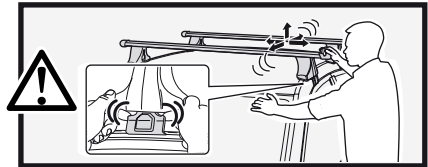

750

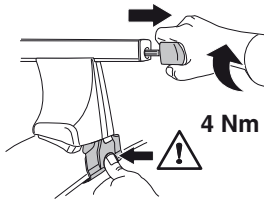

4 Nm

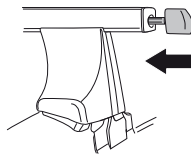

i

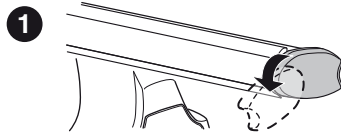

1

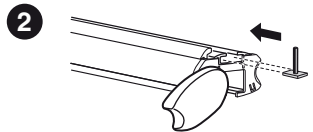

2

i

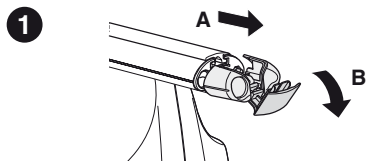
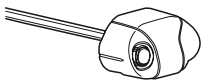

1

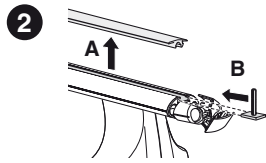

2

i

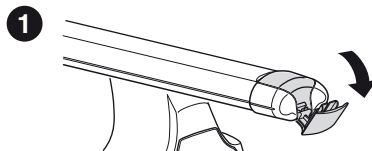

1

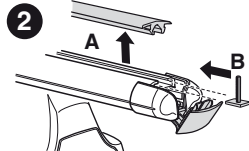

2



THULE
SWEDEN
**ONE
KEY
SYSTEM**



- 544** (x4)
- 596** (x6)
- 588** (x8)
- NA **510** (x10)
- EUR **452** (x12)
- ASIA



WW ▶ Thule Sweden AB, Box 69, 330 33 Hillerstorp, SWEDEN
NA ▶ Thule Inc., 42 Silvermine Road, Seymour, Connecticut 06483, USA

info@thule.com
customer.service@thule.com

www.thule.com